



PRODUCT CATALOGUE





FOR THE PERFECT FINISH



Swissparkett
SOLID WOOD FLOORING



WHO ARE WE

Welcome to Swisstek Ceylon PLC, a pioneering force in the flooring market since its inception in 1967 as Parquet (Ceylon) Ltd. Over the years, we have grown and evolved, culminating in our listing on the prestigious Colombo Stock Exchange in 1983.

Our corporate landscape was further fortified in 2003 when we joined forces with the esteemed Lanka Walltiles Group. With an unwavering commitment to excellence, we attained ISO 9001 certification in 2015 and subsequently changed our name to Swisstek Ceylon PLC in 2011. As we proudly celebrated 50 years of unrivaled service in 2017, we embarked on the challenge of introducing innovative products that redefine the market.

At Swisstek, our passion for manufacturing Tile Adhesive, Waterproofing solutions, Tile Grout, Skim coat and other exceptional products knows no bounds. We strive to exceed the expectations of our esteemed customers by upholding the highest standards in every aspect of our operations. This commitment extends to the continual development of our talented human resources, sourcing and utilizing only the finest materials, upgrading our technical facilities, adhering to the ISO 9001:2015-based management system and ensuring compliance with all statutory and industrial regulations. We take great pride in being the only brand certified with SLS. What sets us apart is our prestigious distinction as the sole brand to obtain SLS certification. We proudly stand as trailblazers, being the first brand to achieve this distinction and the only brand to offer SLS certified products.





SWISSTEK

SWISSTEK (CEYLON) PLC

මධ්‍යම ප්‍රදේශයේ පිහිටි
FACTORY OUTLET & STORES

SWISSTEK



OUR VISION

To be a leading manufacturer in Sri Lanka's construction industry recognised for Innovation and Sustainability-led solutions in fixing, finishing, and beautifying products and services.



OUR MISSION

At Swisstek Ceylon, our mission is to revolutionise the construction landscape in Sri Lanka through relentless dedication to innovation, sustainability, and excellence. We strive to lead by example, consistently providing top-tier solutions in fixing, finishing, and beautification categories that exceed industry standards. Our commitment extends beyond mere functionality, as we integrate aesthetic appeal seamlessly into our offerings. Central to our ethos is environmental responsibility, driving us to minimise our ecological footprint at every opportunity. Moreover, we prioritise the well-being of the communities we serve, fostering positive impacts through our projects and initiatives. Through these endeavours, we aim to set new benchmarks, inspiring progress and shaping a brighter, more sustainable future for the construction industry and beyond.



OUR VALUES

INTEGRITY

Consistent adherence to moral and ethical principles in all aspects of our operations. It involves being honest, transparent, and ethical in dealings with employees, customers, partners, and the broader community. To us, Integrity means doing what is right, even when it may not be the most convenient or profitable option. It encompasses actions such as honouring commitments, upholding legal and regulatory standards, and treating others with fairness and respect.

INNOVATION

Innovation stands at the heart of Swisstek Ceylon's core values. We are committed to pioneering new ideas, technologies, and approaches that redefine the construction industry in Sri Lanka. With a relentless pursuit of excellence, we foster a culture that encourages creativity, collaboration, and continuous improvement. By pushing boundaries and challenging conventions, we aim to revolutionise the way construction is conceived, executed, and experienced. Our dedication to innovation drives us to anticipate market trends, exceed customer expectations, and create sustainable value for all stakeholders. At Swisstek Ceylon, innovation isn't just a goal; it's our guiding principle, shaping our vision for a brighter, more innovative future in construction.



ACCOUNTABILITY

Every member of our team is empowered to take ownership of their actions and decisions, understanding the impact they have on our projects, partners, and community. We honour our commitments, meet deadlines, and deliver results with unwavering dedication. Accountability isn't just a word to us; it's a fundamental principle that guides our actions, fosters trust, and drives excellence in everything we do. At Swisstek Ceylon, we embrace accountability as the cornerstone of our success and the foundation of our reputation for reliability and excellence in the construction industry.

TEAMWORK

Teamwork is not merely a value at Swisstek Ceylon; it's the very essence of how we operate. We believe that collaboration, cooperation, and mutual support are integral to achieving our shared goals and driving success in the construction industry. At Swisstek Ceylon, every individual is valued as a crucial member of our team, each bringing unique perspectives, skills, and experiences to the table. We foster an environment where teamwork is celebrated, and every voice is heard, fostering creativity, innovation, and synergy. By working together seamlessly, we amplify our collective strengths, overcome challenges, and deliver exceptional results that exceed expectations. Teamwork isn't just a value; it's our way of life at Swisstek Ceylon, empowering us to build not only structures but also lasting relationships and a vibrant community within our organisation and beyond.



ISO 9001:2015 CERTIFICATION

Through this certification, the Sri Lanka Standard Institution certifies that the Quality Management System of Swisstek Ceylon PLC has been assessed and approved in accordance with the requirements of ISO 9001:2015 since the year 2014.



SLS 1375 CERTIFICATION

Sri Lanka standard institute certifies that Swisstek Tile Adhesive is manufactured as per SLS 1375: 2019 (Specification for ceramic tile adhesive) since year 2021.



SLS 1376 CERTIFICATION

Sri Lanka standard institute certifies that Swisstek Tile Grout is manufactured as per SLS 1376: 2019 (Specification of Ceramic tile grout) since year 2021.



CONTENTS



02 TILE ADHESIVE RANGE

- 03 SUPER TILE ADHESIVE (C2)
- 04 SUPER PLUSTILE ADHESIVE (C2T)
- 05 ULTRA GRIP TILE ADHESIVE (C2TE)
- 06 ULTRA GRIP WHITE TILE ADHESIVE (C2TE)

10 AQUA SHIELD 2K WATERPROOFER

14 SW – 101 (EPOXY GROUT)

20 TILE GROUT RANGE

- 19 SUPER POLYMER GROUT (CG2WA)
- 20 POLYMER MODIFIED GROUT (CG2WA)

26 GROUT SEALER

30 TILE CLEANER



32 QUICK FLOW AND PRIMER

36 SKIM COAT RANGE

35 DELUXE SKIM COAT

36 PREMIUM SKIM COAT

42 DECORATIVE PEBBLES

44 GENERAL PURPOSE NON-ACIDIC SILICONE

48 ROOF MASTER RANGE

49 ROOFING SHEETS

50 ROOFING TILES

51 CLADDINGS

52 CEILING PANELS

53 CURVE SHEETS

54 GUTTERS AND ACCESSORIES

57 C PURLINS

60 SWISSPARKETT WOODEN FLOORING



TILE ADHESIVE RANGE

Swisstek Tile Adhesive is manufactured in accordance with international standards and the ISO 9001:2015 quality management system. The company conducts frequent inspections in independent laboratories both local and international to maintain the premium standards of its output. Swisstek's Tile Adhesive can be used for the installation of ceramic tiles, porcelain tiles, vitrified porcelain tiles, marble tiles, mosaic tiles, granite and other materials used on both walls and floors. The product is formulated with cement, ceramic fillers, polymer, and a unique binding agent, all of which improve the product's resistance to water while increasing strength and longevity.



**SUPER
TILE
ADHESIVE**



**SUPER PLUS
TILE
ADHESIVE**



**ULTRA GRIP
TILE
ADHESIVE**



**ULTRA GRIP
WHITE TILE
ADHESIVE**

Applicable tile size	2 ft x 2 ft and below	Below 2 ft x 4 ft	2 ft x 4 ft and above	2 ft x 4 ft and above
Surface	New Floors	New and Old Floors	New and Old Floors	New and Old Floors
Tile on tile	No	Yes (with roughening)	Yes	Yes
Internal / Externals	Internal only	Internal and External	Internal and External	Internal and External
Floors/Walls	Floor only	Floors and Walls	Floors and Walls	Floors and Walls
Grouting	24 hrs	24 hrs	24 hrs	24 hrs
Set time	20 min	20 min	30 min	30 min
Ready to use floor	24 hrs	24 hrs	24hrs	24hrs
Bathrooms	No	Yes	Yes	Yes
Roof tops	No	No	Yes	Yes
Swimming pools	No	No	Yes	Yes
Color	Grey	Grey	Grey	White

Ceramic tiles	✓	✓	✓	✓
Porcelain tiles	✓	✓	✓	✓
Vitrified porcelain tiles	✗	✓	✓	✓
Mosaics	✗	✓	✓	✓
Terra Cotta	✓	✓	✓	✓
Granite	✗	✓	✓	✓
Glass mosaics	✗	✗	✓	✓
Marbles	✗	✗	✓	✓

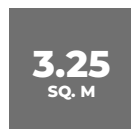

COVERAGE AREA

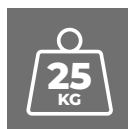

25KG
PER BAG



JUST ADD
WATER



2 YEAR
SHELF LIFE



SUPER TILE ADHESIVE (C2)

Swisstek's Super Tile Adhesive, the proven formula for basic porcelain and ceramic tile application on a freshly built cement screed surface. This product is intended for use in dry, indoor environments. This product meets C2 quality standards and adheres to SLS 1375 quality standards.

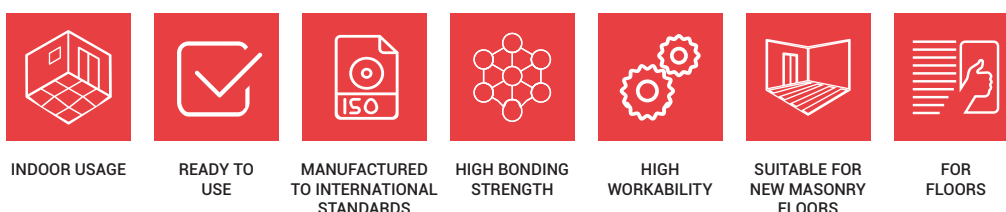

Tensile Adhesion Strength (Test method : SLS ISO 13007-2 : 2013)	Swisstek Super Tile Adhesive Performance	Requirement as per SLS 1375: 2009 (C2)
Normal after 28 days	1.2	$\geq 1\text{N/mm}^2$
Heat aging after 28 days	1.0	$\geq 1\text{N/mm}^2$
Water immersion after 28 days	1.0	$\geq 1\text{N/mm}^2$
Freeze thaw cycles after 28 days	1.1	$\geq 1\text{N/mm}^2$

Open Time Tensile Adhesion Strength (Test method : SLS ISO 13007-2 : 2013)	Swisstek Super Tile Adhesive Performance	Requirement as per SLS 1375: 2009 (C2)
After 5 min	1.2	$\geq 0.5\text{N/mm}^2$
After 10 min	1.1	$\geq 0.5\text{N/mm}^2$
After 20 min	0.5	$\geq 0.5\text{N/mm}^2$

Other Components	Swisstek Super Tile Adhesive Performance	Requirement as per SLS 1375: 2009 (C2)
Pot Life (hr)	1 hr	Not defined



SUPER PLUS TILE ADHESIVE (C2T)

Swisstek's Super Plus Tile Adhesive was specifically designed and manufactured with damp/wet areas in mind. It is perfect for use on bathroom floors and walls, as well as for securing tiles to freshly completed cement screed surfaces and existing cement surfaces. This Adhesive can be used to apply tiles to tiles after roughing. This product meets C2T quality standards and adheres to SLS 1375 quality standards.



INDOOR &
OUTDOOR USAGE



READY TO
USE



MANUFACTURED
TO INTERNATIONAL
STANDARDS



EXCELLENT
BONDING
STRENGTH



EXCELLENT
WORKABILITY



FOR
FLOORS AND
WALLS



SUITABLE FOR
BOTH NEW AND
EXISTING
MASONRY FLOORS



TILE ON TILE
APPLICATION
(AFTER
ROUGHENING)

Tensile Adhesion Strength (Test method : SLS ISO 13007-2 : 2013)

Normal after 28 days
Heat aging after 28 days
Water immersion after 28 days
Freeze thaw cycles after 28 days

Swisstek Super Tile Adhesive Performance

1.2
1.0
1.0
1.1

Requirement as per SLS 1375: 2009 (C2)

$\geq 1\text{N/mm}^2$
 $\geq 1\text{N/mm}^2$
 $\geq 1\text{N/mm}^2$
 $\geq 1\text{N/mm}^2$

Open Time Tensile Adhesion Strength (Test method : SLS ISO 13007-2 : 2013)

After 5 min
After 10 min
After 20 min

Swisstek Super Tile Adhesive Performance

1.8
1.5
0.9

Requirement as per SLS 1375: 2009 (C2)

$\geq 0.5\text{N/mm}^2$
 $\geq 0.5\text{N/mm}^2$
 $\geq 0.5\text{N/mm}^2$

Other Components

Pot Life (hr)
Slip resistance (Test method : SLS ISO 13007-2 : 2013)

Swisstek Super Tile Adhesive Performance

1.5 hr
0.16

Requirement as per SLS 1375: 2009 (C2)

Not defined
 $\leq 0.5\text{mm}$



ULTRA GRIP TILE ADHESIVE (C2TE)

Swisstek's Ultra Grip Tile Adhesive is the go-to for the wettest of wet locations, with features including high flexibility, strong adherence, and anti-slipperiness. Swimming pools, water tanks, and even open surfaces like rooftops with strong thermal expansion and contraction are examples. It can be used with any type of tile on both fresh and weathered cement screed. This product's adhesion is so strong that it may be used directly to apply tiles to tiles. This product meets C2TE quality standards and SLS 1375 quality standards.



INDOOR &
OUTDOOR USAGE



READY TO
USE



MANUFACTURED
TO INTERNATIONAL
STANDARDS



EXCELLENT
BONDING
STRENGTH



EXCELLENT
WORKABILITY



RESISTANCE
FOR EXTREME
WEATHER
CONDITIONS



FOR
FLOORS AND
WALLS



TILE ON TILE
APPLICATION



SUITABLE FOR BOTH
NEW AND EXISTING
MASONRY FLOORS
MASONRY SURFACES

Tensile Adhesion Strength (Test method : SLS ISO 13007-2 : 2013)

Normal after 28 days
Heat aging after 28 days
Water immersion after 28 days
Freeze thaw cycles after 28 days

Swisstek ultra grip Tile Adhesive Performance

1.3
1.0
1.0
1.1

Requirement as per SLS 1375: 2009 (C2)

$\geq 1\text{N/mm}^2$
 $\geq 1\text{N/mm}^2$
 $\geq 1\text{N/mm}^2$
 $\geq 1\text{N/mm}^2$

Open Time Tensile Adhesion Strength (Test method : SLS ISO 13007-2 : 2013)

After 5 min
After 10 min
After 20 min
After 30 min

Swisstek Ultra grip Tile Adhesive Performance

1.9
1.5
1.3
1.1

Requirement as per SLS 1375: 2009 (C2)

$\geq 0.5\text{N/mm}^2$
 $\geq 0.5\text{N/mm}^2$
 $\geq 0.5\text{N/mm}^2$
 $\geq 0.5\text{N/mm}^2$

Other Components

Pot Life (hr)
Slip resistance (Test method : SLS ISO 13007-2 : 2013)

Swisstek Ultra grip Tile Adhesive Performance

1.5 Hr
0.17

Requirement as per SLS 1375: 2009 (C2)

Not defined
 $\leq 0.5\text{mm}$



ULTRA GRIP WHITE TILE ADHESIVE (C2TE)

It has great bonding and anti-slip qualities. White in color. Ideal for marble and glass mosaic tiles. High water resistance and resistance to thermal expansion and contraction. It can be used with any type of tile on both fresh and weathered cement screed. This product's adhesion is so strong that it may be used directly to apply tiles to tiles. This product meets C2TE quality standards.



INDOOR &
OUTDOOR USAGE



READY TO
USE



MANUFACTURED
TO INTERNATIONAL
STANDARDS



EXCELLENT
BONDING
STRENGTH



EXCELLENT
WORKABILITY



RESISTANCE
FOR EXTREME
WEATHER
CONDITIONS



FOR
FLOORS AND
WALLS



TILE ON TILE
APPLICATION



SUITABLE FOR
BOTH NEW
AND EXISTING
MASONRY FLOORS

Tensile Adhesion Strength (Test method : SLS ISO 13007-2 : 2013)

Normal after 28 days
Heat aging after 28 days
Water immersion after 28 days

Swisstek ultra grip Tile Adhesive Performance

1.2
1.0
1.1

Requirement as per SLS 1375: 2009 (C2)

$\geq 1\text{N/mm}^2$
 $\geq 1\text{N/mm}^2$
 $\geq 1\text{N/mm}^2$

Open Time Tensile Adhesion Strength (Test method : SLS ISO 13007-2 : 2013)

After 5 min
After 10 min
After 20 min
After 30 min

Swisstek Ultra grip Tile Adhesive Performance

1.0
0.9
0.8
0.8

Requirement as per SLS 1375: 2009 (C2)

$\geq 0.5\text{N/mm}^2$
 $\geq 0.5\text{N/mm}^2$
 $\geq 0.5\text{N/mm}^2$
 $\geq 0.5\text{N/mm}^2$

Other Components

Pot Life (hr)
Slip resistance (Test method : SLS ISO 13007-2 : 2013)

Swisstek Ultra grip Tile Adhesive Performance

1.5 Hr
0.18

Requirement as per SLS 1375: 2009 (C2)

Not defined
 $\leq 0.5\text{mm}$

TILE ADHESIVE RANGE

PRODUCT FEATURES

Coverage area per bag (25Kg) of Swisstek tile adhesive

TILE SIZE / 25KG PER BAG	COVERAGE AREA SQFT / 25KG PER BAG
TILES 16" OR LESS	45-50
ABOVE THE 6" TILES	30-40

Recommended trowel notches

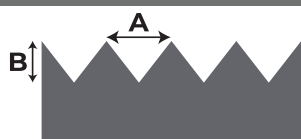

$\frac{1}{4}"(A) \times \frac{1}{4}"(B)$ or
6mm(A) X 6mm(B)

FLOOR TILES & WALL TILES
16" OR LESS

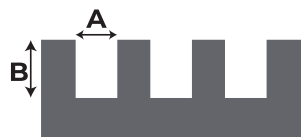

$\frac{1}{4}"(A) \times \frac{3}{8}"(B)$ or
6mm(A) X 9mm(B)

FLOOR TILES AND WALL TILES
MORE THAN 16" UP TO 24"

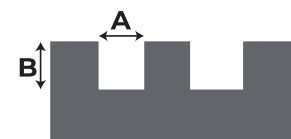

$\frac{1}{2}"(A) \times \frac{1}{2}"(B)$ or
12mm(A) X 12mm(B)

MARBLE, GRANITE,
FLOOR TILE OR WALL TILE SIZE
EXCEEDING 24"

TILE ADHESIVE RANGE

SURFACE PREPARATION

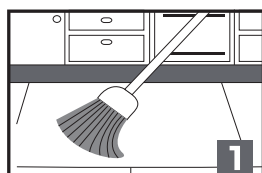

1
Clean the levelled sub floor surface thoroughly and remove any dust, oil, sealers etc. Wet the surface of the sub floor, before applying SWISSTEK.

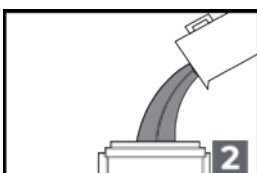

2
Fill a container with 7-8 litres of water.

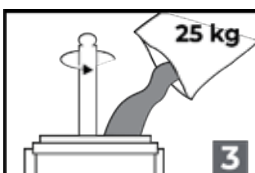

3
Mix in the contents (25kg) of the Adhesive pack.

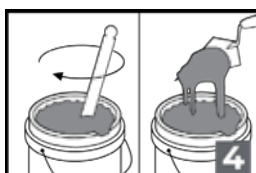

4
Make sure the Adhesive and water is mixed thoroughly. A stirring machine is recommended for proper mixing.



5
Apply the mixture to the surface (Wall/Floor) with a recommended notched trowel. Fix tiles within 20minutes of application.



6
Place tiles with a minimum gap of 3mm.



7
Use a rubber hammer to adjust the level and lines of tiles.

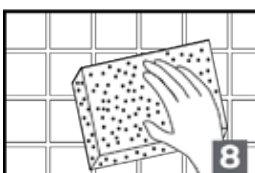

8
Wipe Off any excess Adhesive from the tile surface.



9
Please wait 24 hours for tiles to be fully and firmly fixed.

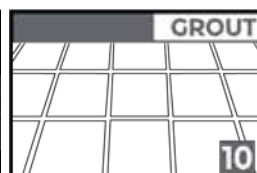

10
For the best finish, use Swisstek Grout and Grout Sealer







AQUA SHIELD 2K WATERPROOFER

Swisstek Aqua Shield 2K Waterproofing, a top-of-the-line solution that guarantees to keep structures protected against water damage. Formulated with a cementitious base and expertly blended with graded aggregates and specially designed acrylic additives, Swisstek Aqua Shield 2K Waterproofing is a true testament to advanced waterproofing technology. Swisstek Aqua Shield is perfect for safeguarding concrete slabs, rooftops, columns, retaining walls, bases, foundations, pile caps, swimming pools, water tanks, bathrooms and kitchens from the harmful effects of water exposure.

Test	PERFORMANCE
Color of the Slurry	Dark grey with no smell
Workability	Good
Pot life(hr)	> 3 hrs
Over coat Time	4 hr
Cured film membrane	Flexible
Tensile adhesion strength under standard condition	$\geq 0.5\text{N/mm}^2$
Water Impermeability Test-2.0 bar for 7 Days	Pass
Crack bridging ability	$\geq 2.0\text{ mm}$

AQUA SHIELD FEATURES

1. Prevents Water Penetration.
2. Easily Applied By Brush.
3. Flexible And Elastic.
4. Excellent Adhesion To Concrete And Masonry Substrate (High Tensile Strength).
5. Crack Bridging Property.
6. Resistance To Chloride Ion Diffusion.
7. Compatible With Ceramic Tile Adhesives.
8. Non-corrosive.
9. 1 year shelf life.

AQUA SHIELD

MIXING



Before mixing, shake liquid B well.

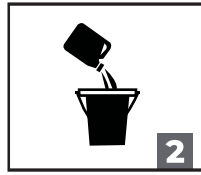

Pour the entire contents of liquid B (2 Kg) in to the mixing bucket.



Slowly add powder A(3 Kg) in to the bucket while mixing.

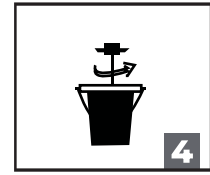

Use a low speed mechanical mixer to mix the two components in to a uniform slurry.

***IF YOU OBSERVE ANY DEPOSITION AT THE BOTTOM (COMMONLY HAPPENS WITH TIME) OF THE CONTAINER, PLEASE USE A CLEANED STICK TO MIX THE DEPOSITED LAYER AND THEN MIX WELL UNTIL IT BECOMES UNIFORM MIXTURE.**

AQUA SHIELD

APPLICATION

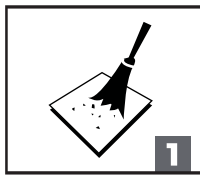

Remove all impurities and loosely adhering material from the surface. Use a wire brush and thoroughly lean the surface. Vacuum off the resulting residue/ powder.



Wash the area with clean water and the substrate should be damp, without water,

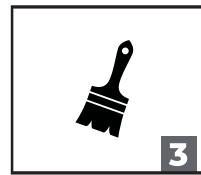

Use a masonry float or brush to apply the mixed Aqua Shield Waterproofing coating.



The first coat (0.8mm - 1 mm) should be applied in a vertical direction to cover the entire area.

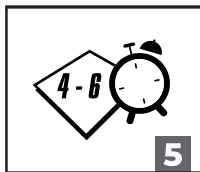

The first coat should dry for 4-6 hours.



The second coat (0.8mm - 1 mm) should be applied in a horizontal direction.

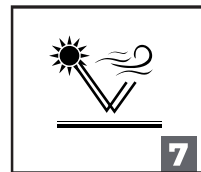

The application area should be covered from sunlight and wind to prevent shrinkage.



Curing by air is sufficient.

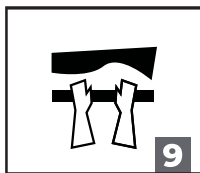

Once the waterproof is dried apply a protective screed on the water proofed area.

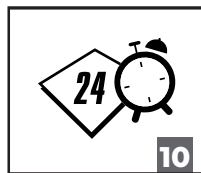

The waterproofed surface may be used only after 24 hours of curing.

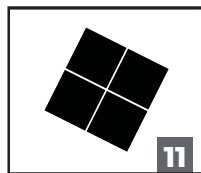

For Swimming pools the waterproofed surface may be used only after 7 days of curing.

AQUA SHIELD

APPLICATION



5kg

30
sq. ft

2 Layers of 1mm
Thickness



25kg

150
sq. ft

2 Layers of 1mm
Thickness

***COVERAGE MAY VARY ACCORDING TO THE FLATNESS OF THE SURFACE.**

AQUA SHIELD

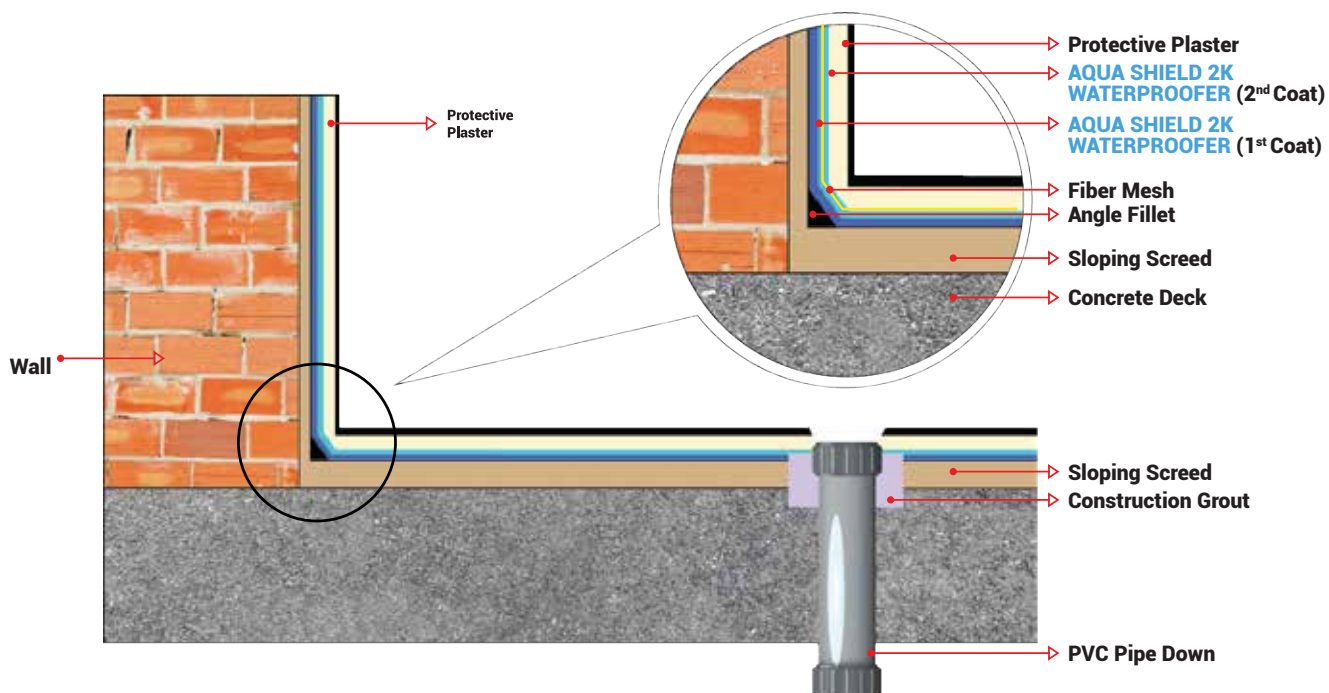

***THE VISUAL REPRESENTATION DOES NOT ADHERE TO ACTUAL RATIOS; IT IS INTENDED SOLELY FOR ILLUSTRATIVE PURPOSES.**



SW – 101 (EPOXY GROUT)



Swisstek SW – 101 is a cutting edge solution designed to revolutionize your tiling projects. Crafted with meticulous precision, SW – 101 grout is not your average grouting material; it's a true game-changer in the world of construction.

SW – 101 is a hygienic, hard-wearing, impervious, epoxide resin-based grout with a high degree of resistance to chemical attack, abrasion, and impact. The cured grout does not transfer taints to foodstuffs, does not permit the entry of bacteria or dirt and is easily maintained in a sterile condition.

But the true brilliance of our SW – 101 grout lies in its ability to preserve the purity of your environment. Unlike conventional grouts, the cured surface of our SW – 101 grout leaves no room for taints to leach into foodstuffs. Whether you're in a commercial kitchen, a food processing area, or any space where hygiene is paramount, rest assured that our SW – 101 will pass the test with flying colors. We are committed to ensuring the safety of our products for our customers, including those engaged in artistic and craft-related activities. Our epoxy resin and hardener comply with the safety standards ASTM D4236 and EN 71.

EXCELLENT CHEMICAL RESISTANCE	100% STAIN FREE	100% WATERPROOF	ANTIBACTERIAL AND ANTIFUNGAL	WITHSTANDS HIGH TEMPERATURES	COVERAGE AREA 37.5 SQ. M	5 KG PACK	2 YEARS SHELF LIFE

***MENTIONED COVERAGE IS WHEN APPLYING FOR 2 X 2 TILES (3MM WIDTH AND 3MM DEPTH OF A GROUT GROVE), COVERAGE MAY VARY DEPENDING ON THE TILE SIZE, THE WIDTH AND DEPTH OF THE GROUT GROVE.**

SW – 101 FEATURES

1. VOC Free (Zero Volatile Organic Compounds).
2. No BPA (Do not contain any traces of Bisphenol-A).
3. Not classified as dangerous goods by the criteria for transport by road, rail, International Maritime Dangerous Goods Code (MDG code) for transport by sea and International Air Transport Association (IATA) dangerous goods regulations for transport by air.

SW – 101 AREAS OF APPLICATION



BATHROOMS



SWIMMING POOLS



STEAM ROOMS



SPLASHBACKS

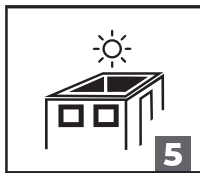

ROOF TOPS

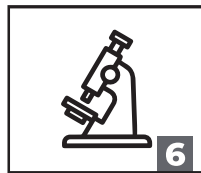

**LABORATORIES AND
HOSPITALS**



**HIGH FOOT
TRAFFIC AREAS**



**INTERIOR AND
EXTERIOR USAGE**

SW – 101 APPLICATION PROCESS

1. Mix the two liquid components and solid powder as per given ratios using a mixer.
2. Apply the SW-101 mixture between tiles evenly with a rubber-faced grouting trowel or float. Remove excess grout.
3. Don't wait too long to remove excess grout to minimize residue.
4. Wet the surface with water and use a scrubbing pad to clean grout residue. Change the water if it gets sticky.
5. Thoroughly clean the surface with clean water and a sponge within a day to prevent stickiness.
6. Allow a minimum of 24 hours for curing, avoiding any foot traffic during this period.

SW – 101 CONTENTS OF 5KG PACK



HARDENER 175G X 2



RESIN 525G X 2



FILLER POWDER 1.8KG X 2

SW - 101 INCLUDED FREE



GLOVES

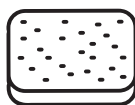

MICROFIBRE CLOTH



GROUTING TROWEL

SW - 101 AVAILABLE COLOURS

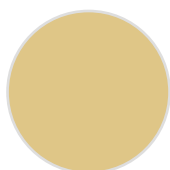

IVORY
WHISPER
[EX-G-05]

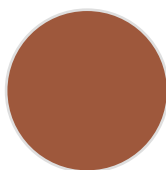

BUTTERCREAM
GLOW
[EX-G-15]

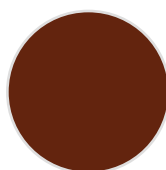

HONEY
BROWN
[EX-G-25]

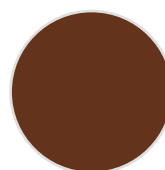

TERRACOTTA
EARTH
[EX-G-80]

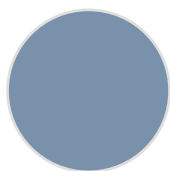

DENIMBLUE
[EX-G-85]

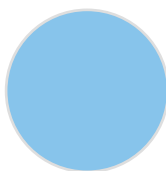

SERENITY
BLUE
[EX-G-40]

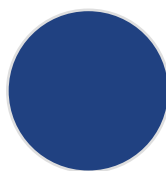

OCEAN
BLUE
[EX-G-42]

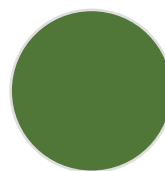

MEADOW
GREEN
[EX-G-51]



CRYSTAL
WHITE
[EX-G-01]

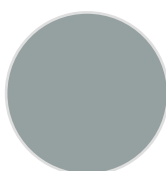

SILVER
GRAY
[EX-G-74]

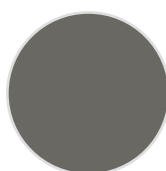

SLATE
GRAY
[EX-G-10]

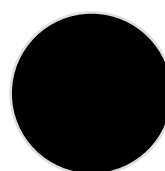

ONYX
BLACK
[EX-G-60]

***PLEASE NOTE THAT PRODUCT COLORS MAY DIFFER FROM THOSE SHOWN IN THE CATALOG DUE TO VARIATIONS IN PRINT PRODUCTION.**

SW – 101 TECHNICAL INFORMATION

Physical Properties of Epoxy Grout at 27 ± 1°C	
Pot Life	60 minutes
Foot Traffic:	24 hours
Full Cure	7 days (For Swimming Pools)
Temperature	Prolonged 5°C to 50°C
Resistance	Intermittent up to 70°C
VOC Content	Free
BPA	No
Specific gravity	1.3 -1.6

SW – 101 PROPERTIES TESTED TO ISO 13007-4:2013

Fundamental Characteristics (Test Method: ISO13007-4:2013)	SW – 101 Performance	Minimum Requirement as per ISO13007-4:2013
Flexural Strength	40.7 N/mm ²	≥ 30N/mm ²
Compressive Strength	85.0 N/mm ²	≥ 45N/mm ²
Water Absorption (After 240 mins)	0.03 g	≤ 0.1g

SW – 101 CAN BE USED AS AN EPOXY ADHESIVE

Tested Surfaces	Tensile Adhesion Strength
Concrete	2.7 N/mm ²
Tile on tile	2.3 N/mm ²
Plywood	0.9 N/mm ²
Backer Board	0.5 N/mm ²

TEST METHOD : ISO 13007-2

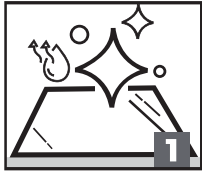

Prior to application, ensure that all surfaces are dry and free from any standing water.

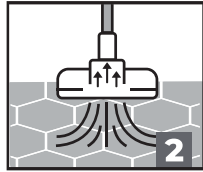

Remove any residue and clean the grouting grooves. Using a vacuum is recommended.

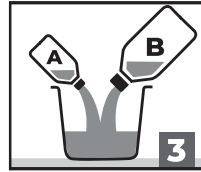

Pour the Hardener, and Resin (1 bottle each) into a container.



Mix the Hardener, and Resin for 2 minutes. Use 300rpm mixing speed.



A mechanically powered mixer or a drill fitted with a helix type paddle should be used to ensure proper mixing.

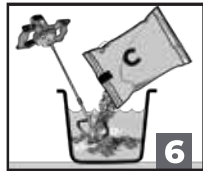

Gradually add the filler powder (1 pack) while mixing. Continue for 3 minutes or until a uniform consistency is obtained.

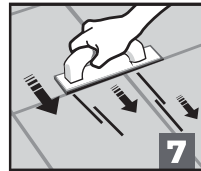

The grout should be applied only in one direction, not both ways.



Once Hardener, Resin and Filler Powder is mixed, apply grout as soon as possible (within a period of 1 hour).



Remove any grout remaining on the tile surface before it hardens (this needs to be done within 1 hour of mixing).

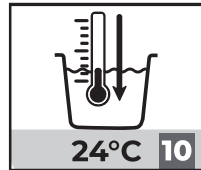

If temperatures are less than 24°C, the cure rate will be slow.

**USING MASKING TAPE IS RECOMMENDED, WHEN APPLYING ON ROUGH TILES.
CONTACT TECHNICAL SUPPORT FOR INSTRUCTIONS, WHEN APPLYING ON PRINTED TILES.**

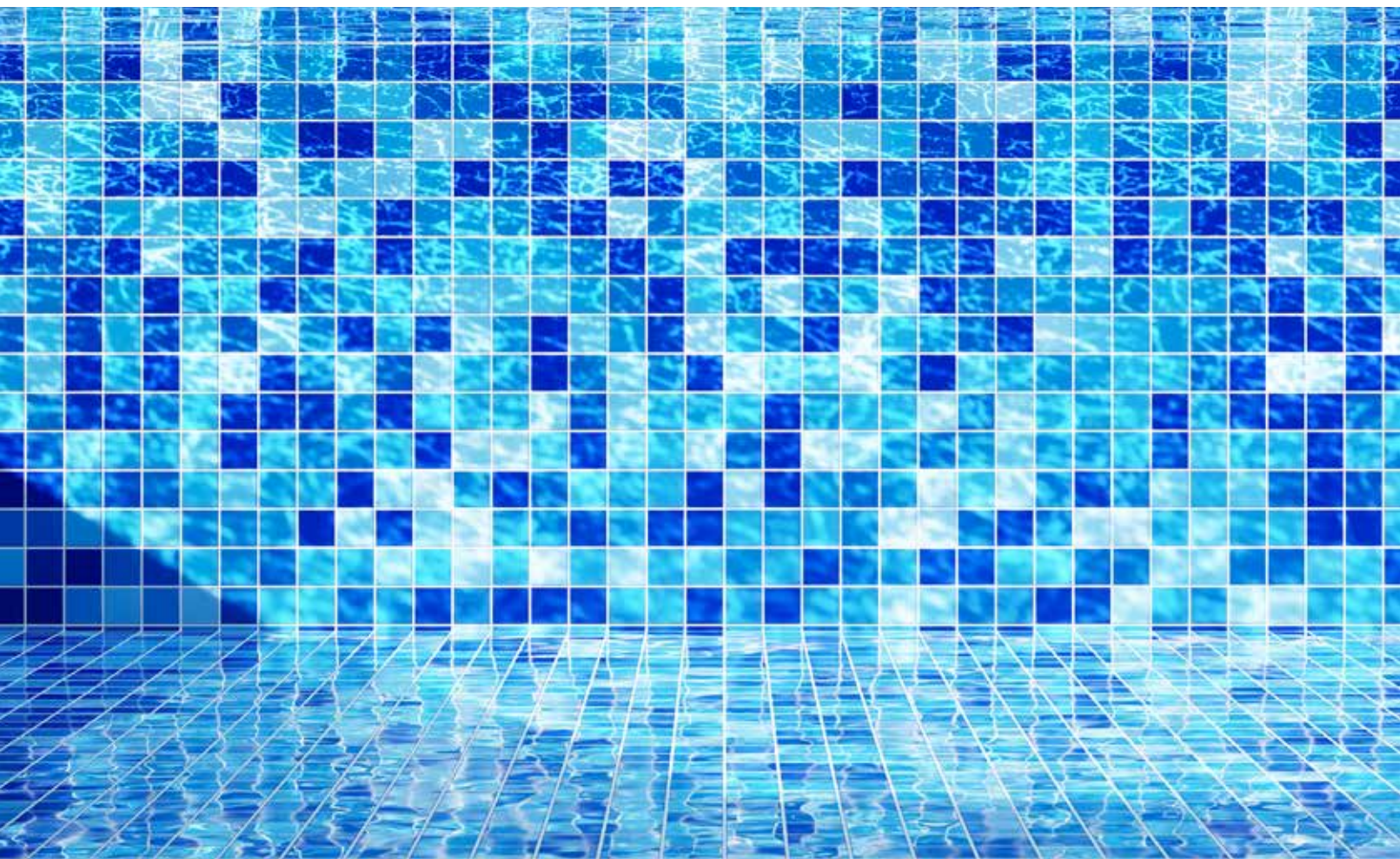

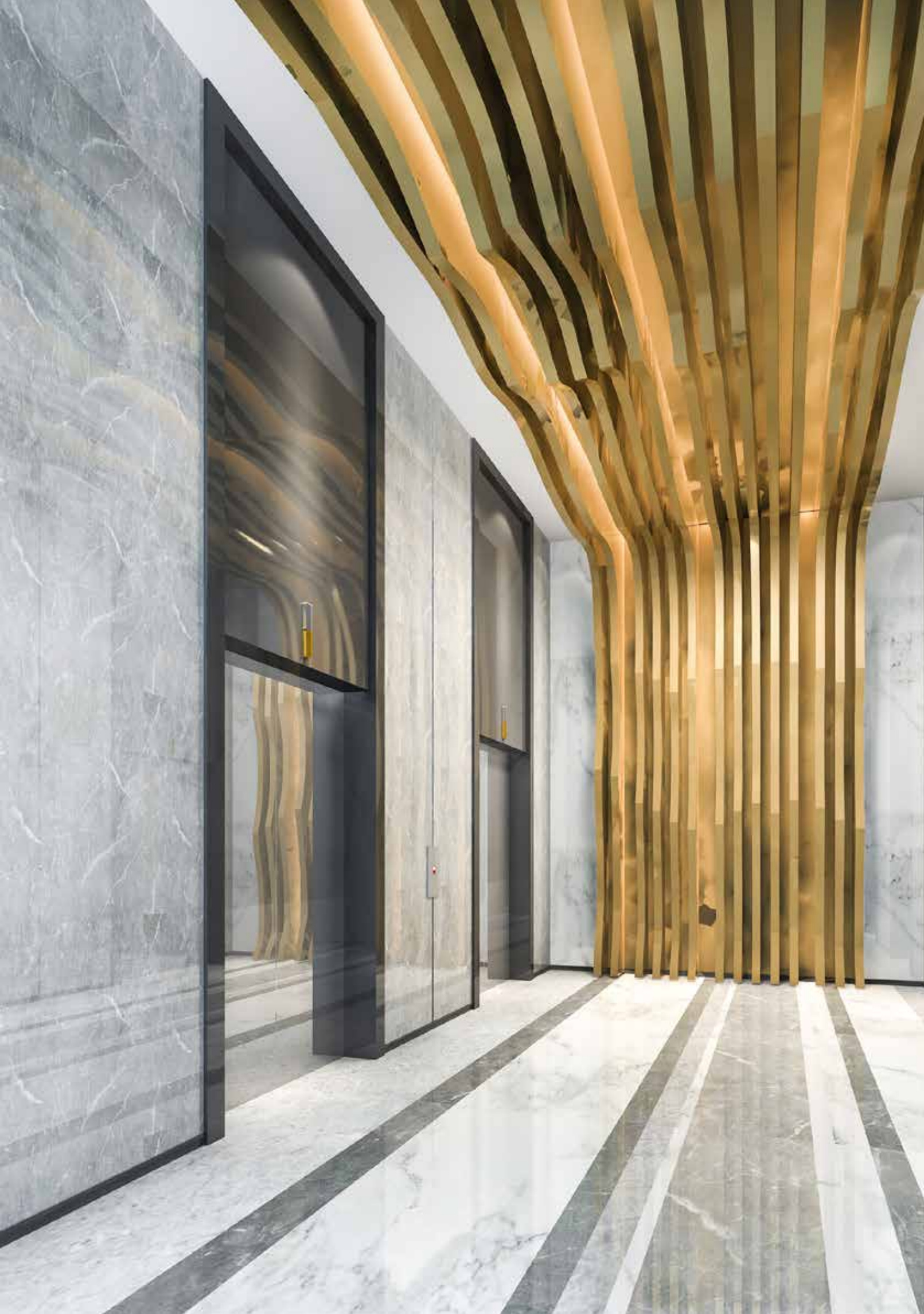

TILE GROUT RANGE

With 25 colors for the customer to choose from, Swisstek Tile Grout is ISO certified and is the only SLS Certified product of its kind available in the Sri Lankan market. The company adheres to the highest quality standards in its creation and conducts regular examinations within independent laboratories to verify that all guidelines are followed. This unfading and non-perishable tile grout is perfect for joints between one and six millimeters (1mm-6mm) in width and is well worth every cent spent as every 1 KG pack can cover an area between 80 and 100 square feet (depending on tile size). The benefits are truly endless. This best-seller comes in two distinct formulas, each of which is fitted for a different purpose and surface.



POLYMER GROUT



SUPER POLYMER
GROUT

Internal / External
Floors/Walls
Set time
Ready to use floor
Bathrooms
Roof tops
Swimming pools
Colors

Internal and External
Floors and Walls
20 min
24hrs
Yes
No
No
25 Colors to choose

Internal and External
Floors and Walls
20 min
24hrs
Yes
Yes
Yes
25 Colors to choose

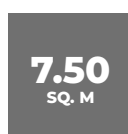

COVERAGE AREA



1KG
PER BAG



JUST ADD
WATER



2 YEAR
SHELF LIFE



POLYMER MODIFIED GROUT (CG2WA)

A superior product with high bonding strength that is dirt and fungus resistant, best fitted for the outdoors or wet spaces, including bathrooms. This product meets CG2WA quality standards and SLS 1376 quality standards.



INDOOR &
OUTDOOR USAGE



EXCELLENT
ABRASION
RESISTANCE



EXCELLENT
BONDING
STRENGTH



EXCELLENT
WATER
RESISTANCE
QUALITY

Fundamental Characteristics (Test method : SLS ISO 13007-4 : 2013)	Swisstek Polymer Modified Grout Performance	Requirement as per SLS 1376: 2009 (CG2)
Flexural strength under standard conditions	06.4	$\geq 2.5\text{N/mm}^2$
Flexural strength after freeze-thaw cycles	06.8	$\geq 2.5\text{N/mm}^2$
Compressive strength under standard condition	31.5	$\geq 15\text{N/mm}^2$
Compressive strength after freeze-thaw cycles	42.4	$\geq 15\text{N/mm}^2$
Shrinkage	01.2	$\leq 3\text{mm/m}$

Additional Characteristics	Swisstek Polymer Modified Grout Performance	Requirement as per SLS 1375: 2009
High abrasion resistance	405	$\leq 1000\text{ mm}^3$
Water absorption after 30 min	0.46	$\leq 2\text{g}$
Water absorption after 240 min	0.67	$\leq 5\text{g}$



SUPER POLYMER GROUT (CG2WA)

An ultra-fine solution with excellent bonding strength that is dirt and fungus resistant. SUPER POLYMER GROUT's water-repelling property is specially formulated for narrow grooves and waterlogged surfaces such as swimming pools and water tanks. This product meets CG2WA quality standards and SLS 1376 quality standards.



INDOOR & OUTDOOR USAGE



EXCELLENT ABRASION RESISTANCE



EXCELLENT BONDING STRENGTH



EXCELLENT WATER RESISTANCE QUALITY



NON-SANDED GROUT/ ULTRA-FINE FORMULATION

Fundamental Characteristics (Test method : SLS ISO 13007-4 : 2013)	Swisstek Super Polymer Grout Performance	Requirement as per SLS 1376: 2009 (CG2)
Flexural strength under standard conditions	06.7	$\geq 2.5\text{N/mm}^2$
Flexural strength after freeze-thaw cycles	07.0	$\geq 2.5\text{N/mm}^2$
Compressive strength under standard condition	30.4	$\geq 15\text{N/mm}^2$
Compressive strength after freeze-thaw cycles	34.1	$\geq 15\text{N/mm}^2$
Shrinkage	01.2	$\leq 3\text{mm/m}$

Additional Characteristics	Swisstek Super Polymer Grout Performance	Requirement as per SLS 1375: 2009
High abrasion resistance	435	$\leq 1000\text{ mm}^3$
Water absorption after 30 min	0.35	$\leq 2\text{g}$
Water absorption after 240 min	0.66	$\leq 5\text{g}$

TILE GROUT RANGE

USAGE AND SURFACES

Swisstek Grout is ideal for grouting joints that are between 1mm and 6mm in width. Mixed with only water, it is easy to use and clean. Swisstek Grout can be used on all types of porous and non-porous floor and wall tiles such as Porcelain, Non-Porcelain, Ceramic, Slate, Granite, Cement-based and Terrazzo, Marble tiles, Glass Mosaics and as well as clay tiles such as Terracotta.



PORCELAIN



NON-PORCELAIN



CERAMIC



SLATE



MARBLE TILES



GRANITE



CEMENT-BASED



TERRAZZO



TERRACOTTA



MOSAICS

TILE GROUT RANGE

PREPARATION BEFORE APPLICATION

1. Before you start applying the grout, make sure the tile adhesive has set firmly. This takes at least 24 hours.
2. Make sure the grouting joints are clean and dry. Remove any spacer lugs such as excess adhesive or any loose foreign material or dirt from the joints.

TILE GROUT RANGE

APPLICATION PROCESS

1. Mix 1kg powder with approximately 0.3 litres (300ml) Of water. Mix well until the grout is easily applied with a trowel. Make sure the mixture is not too thin or thick.
2. Use a rubber faced grouting trowel or a float to apply the grout mixture evenly between the tiles.
3. The grout requires at least 20 minutes to set and dry.
4. Remove excess grout from the surface of the tile with a rubber-faced grouting trowel or rubber float using a diagonal motion.
5. Let the grout dry thoroughly for around 30 minutes. Then use a damp sponge to gently wipe the surface of the tiles to remove any remaining excess grout (If the surface is rough, clean the surface within 15 minutes).
6. Allow at least 24 hours for the grout to harden. Do not wash, trample or step/walk on the surface during this period.
7. For best results, the set grout should be damp-cured for a minimum of 48 hours, thereafter.
8. The proper colour of the grout will show after 48 hours of setting.
9. It is highly recommended to apply a grout sealer after the grouting process.

TILE GROUT RANGE

AVAILABLE COLOURS



**001
WHITE**



**007
LILY
WHITE**



**005
OFF
WHITE**



**014
IVORY**



**015
CREAM**



**061
BAMBOO**

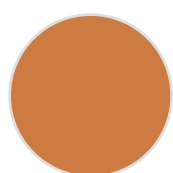

**064
LEATHER
BROWN**

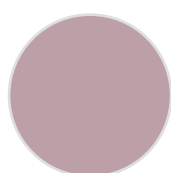

**022
BEIGE**

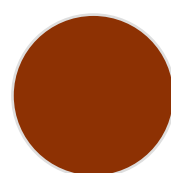

**025
BROWN**

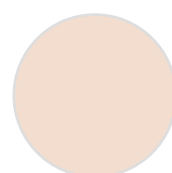

**018
SAHARA
SAND**

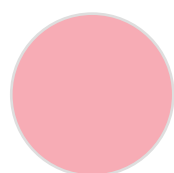

**030
PINK**

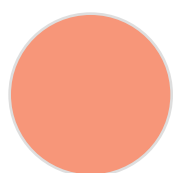

**080
TERRA
COTTA**

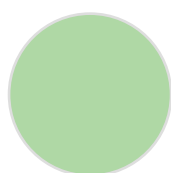

**069
AVACADO
GREEN**

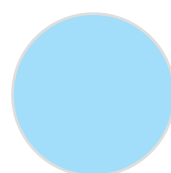

**040
LIGHT
BLUE**

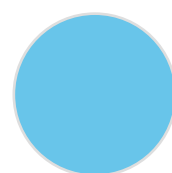

**085
BLUE**

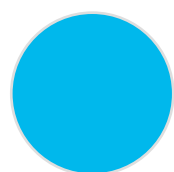

**041
COBLAT
BLUE**

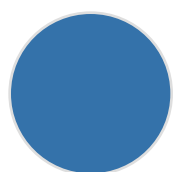

**084
TOURMALINE**

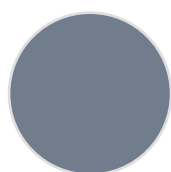

**042
DARK
BLUE**

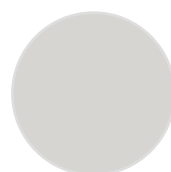

**074
LIGHT
GREY**

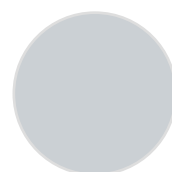

**020
SILVER
GREY**

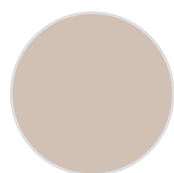

**009
CREAMISH
GREY**

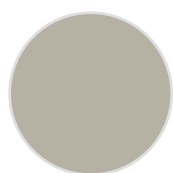

**066
DOVE
GREY**

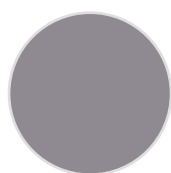

**010
DARK
GREY**

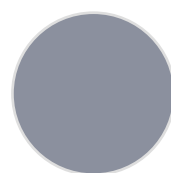

**067
BLUISH
GREY**

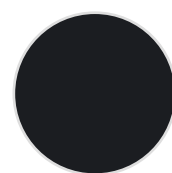

**060
BLACK**

***ACTUAL PRODUCT COLOURS MAY VARY SLIGHTLY FROM THOSE DEPICTED HERE.**

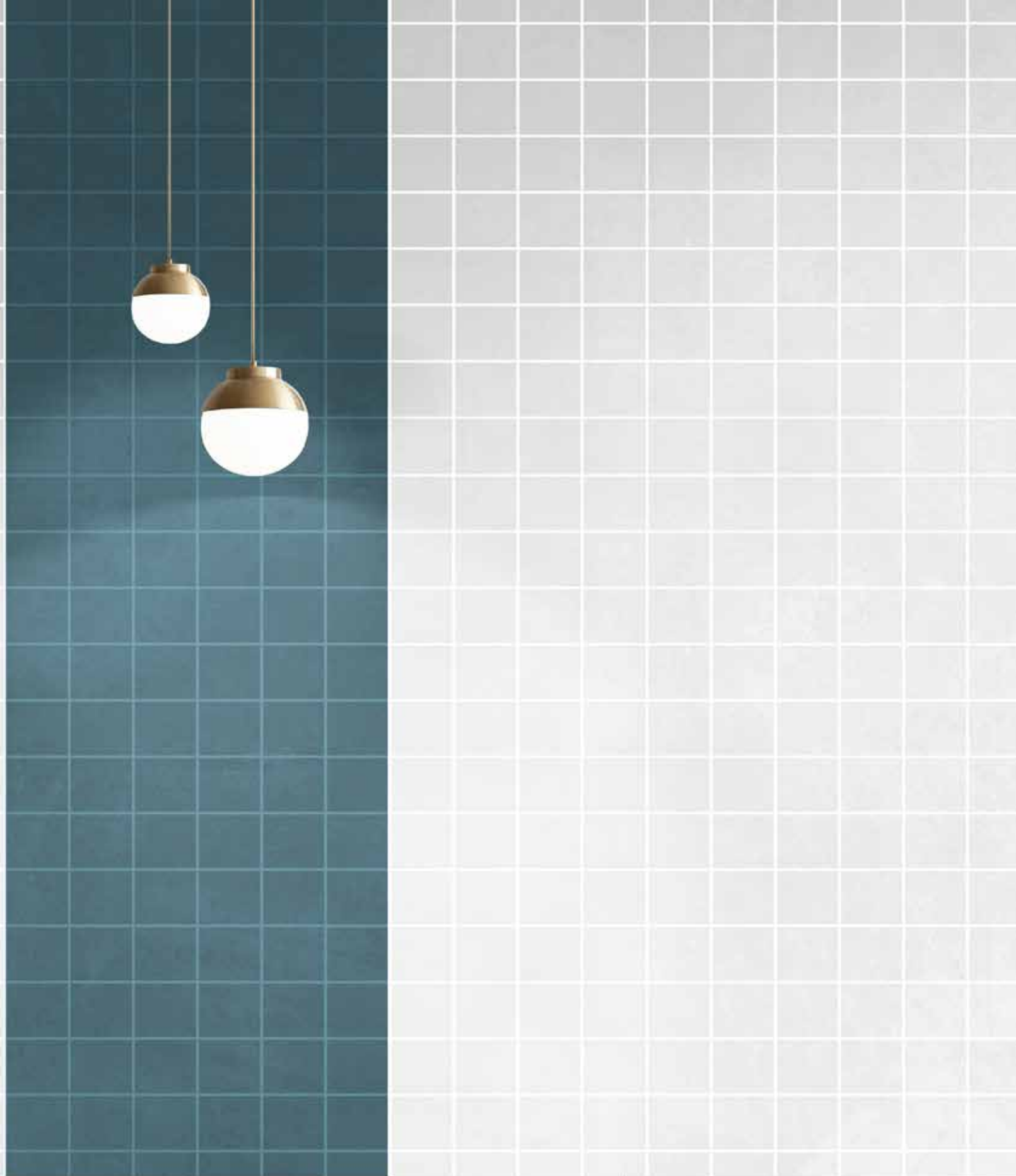



GROUT SEALER

Swisstek Grout Sealer is a water-based penetrating coating liquid that was formulated to protect sanded and unsanded grout joints against moisture and stains. The customer is assured that the lines running in between tiles remain clean and crisp by properly applying this transparent solution along the grout lines.

GROUT SEALER FEATURES

1. Water based and eco-friendly. Economical.
2. Good permeability with no shine and with a natural look.
3. Excellent adhesion and good abrasion resistance.
4. Good water repellent effects and stain protection.
5. For interior and exterior applications.
6. With a unique applicator tip for easy application.
7. 18 months shelf life from MFD.

GROUT SEALER APPLICATION SCOPE

FOR ALL SANDED AND NON-SANDED CEMENTITIOUS GROUT JOINTS.

GROUT SEALER

APPLICATION INSTRUCTIONS

1. The grout joints must be clean, dry and free from all foreign materials.
2. For newly grouted surfaces, apply the grout sealer after 72 hours of application.
3. For existing old floors, you may clean the grout surface by using Swisstek Heavy Dirt Tile Cleaner and allowing the surface to dry for 24 hours before applying the Grout Sealer.
4. Apply the sealer using the unique applicator tip.
5. A second application may be applied within 30 minutes or after to ensure that the first layer has been completely absorbed by the surface.
6. Any grout sealer on an adjoining tile or natural stone must be wiped off with a clean, damp towel within a few minutes of the grout sealer being absorbed by the grout joints.
4. The finished area must be kept for 6 hours in its state for curing.
5. For optimum results, the finished area must be kept dry and free from any staining material for 36 hours.

GROUT SEALER

COVERAGE



1 Bottle (200ml)

400 sq. ft

THE COVERAGE MAY VARY DEPENDING ON THE SURFACE POROSITY, SURFACE ABSORPTION AND APPLICATION METHOD.







TILE CLEANER

Swisstek heavy-dirt tile cleaner is formulated to maintain the natural beauty of tiled surface after installation. It assures all types of tiles and even products such as marble are preserved in their almost original appearance by efficiently removing heavy dust and dirt. 99.9% germ protection, which certified by outsourced laboratory.

TILE CLEANER INGREDIENTS

1. Nonionic/ anionic surfactant mixture
2. EDTA
3. HCL
4. Disinfectant liquid

TILE CLEANER PACKAGING AND AVAILABILITY



500ml



1L

TILE CLEANER DIRECTION TO USE

Tile cleaner can dilute in water in a 1: 5 ratio (maximum), depending on the surface to be cleaned. Do not mix with other cleaning agents





QUICK FLOW AND PRIMER

Swisstek Quick Flow is a cement-based levelling adhesive that is used on concrete floors mixed with water prior to the application of materials like carpet, vinyl, tiles, and parquet. It can be used on concrete floors as a thin layer levelling and scraping adhesive. It is a highly efficient product that is very simple to use. When cured, it offers a seamless, level surface for installing a multitude of floor coverings.

Swisstek Primer is an acrylic based liquid which is applied prior to applying Swisstek Quick floor. The primer acts as a layer prevents air travelling to Quick floor from the concrete as well as the concrete absorbing water from the quick floor mix allowing the mixture to cure properly.

Product Properties	Swisstek Quick Floor	Swisstek Primer
Physical State	Powder	Liquid
Color	Grey	White
Shelf Life	2 years from date of manufacturing/ In seal condition	6 months from date of manufacturing/ In seal condition
Packaging	20 Kg	05 L
Pot Life	20-30 minutes depending on temperature	-
Application Thickness	1-20 mm	-
Compressive strength after 28 days	Approximately 30 MPa	-

QUICK FLOW COVERAGE



5kg

40
sq. ft

3mm (three) screed

SWISSTEK PRIMER SHOULD BE APPLIED ON THE APPLICATION FLOOR AND SLIGHT STICKINESS SHOULD BE THERE AT THE MOMENT OF QUICK FLOW APPLICATION.

PRIMER

COVERAGE



1 Bottle (5L) for 10 Bags
of Swisstek Quick Flow
(20Kg Bag)

375 – 400
sq. ft

THE APPLICATION FLOOR SHOULD BE DAMPED AT THE MOMENT OF SWISSTEK PRIMER APPLICATION.

QUICK FLOW AND PRIMER

APPLICATION INSTRUCTIONS

SURFACE PREPARATION

1. All Surfaces must be clean and free from any loosely adhering particles or contaminants such as dirt, dust, grease, oil and etc.
2. Cement laitance should be removed from the concrete surface.
3. Any existing paints, coatings or floor covering must be removed.

APPLYING THE SWISSTEK PRIMER BEFORE APPLYING THE FLOOR LEVELING COMPOUND IS RECOMMENDED FOR BETTER ADHESION.

MIXING

1. Pour the required amount of water (For a 1 kg use 260ml of clean water, this amount can be adjusted slightly to achieve the desired consistency and the layer thickness.) in to a mixing container and slowly add the powder while mixing continuously with a mixing machine.
2. Thoroughly mix until a uniform, lump free consistency is achieved. A minimum mixing time of 3 minutes is recommended.
3. The consistency can be adjusted by adding slightly more powder or water, if required.

APPLICATION

1. The mixed material should be poured onto the prepared and primed floor surface while the primer is still tacky. If the primer has dried out it should be reapplied to ensure maximum adhesion.
2. After dispersion of material, if needed the compound can be trowelled to gain the desired finish.

CURING TIME

It takes 48 hours to cure the surface. (This may vary with the climate condition). Wet the surface by using water about 4 days after 24 hours in application.

Or cover the applied surface by using the polythene sheet after surface drying.

QUICK FLOW AND PRIMER

IMPORTANT NOTICES

RAPID DRYING OUT DUE TO SUN OR WIND MUST BE AVOIDED AND IN THESE SITUATIONS, FLOOR LEVELING COMPOUND SHOULD BE COVERED WITH POLYTHENE OR WET HESSIAN AFTER APPLICATION.

FLC WILL NOT BRIDGE "LIVE" CRACKS IN CONCRETE FLOORS.

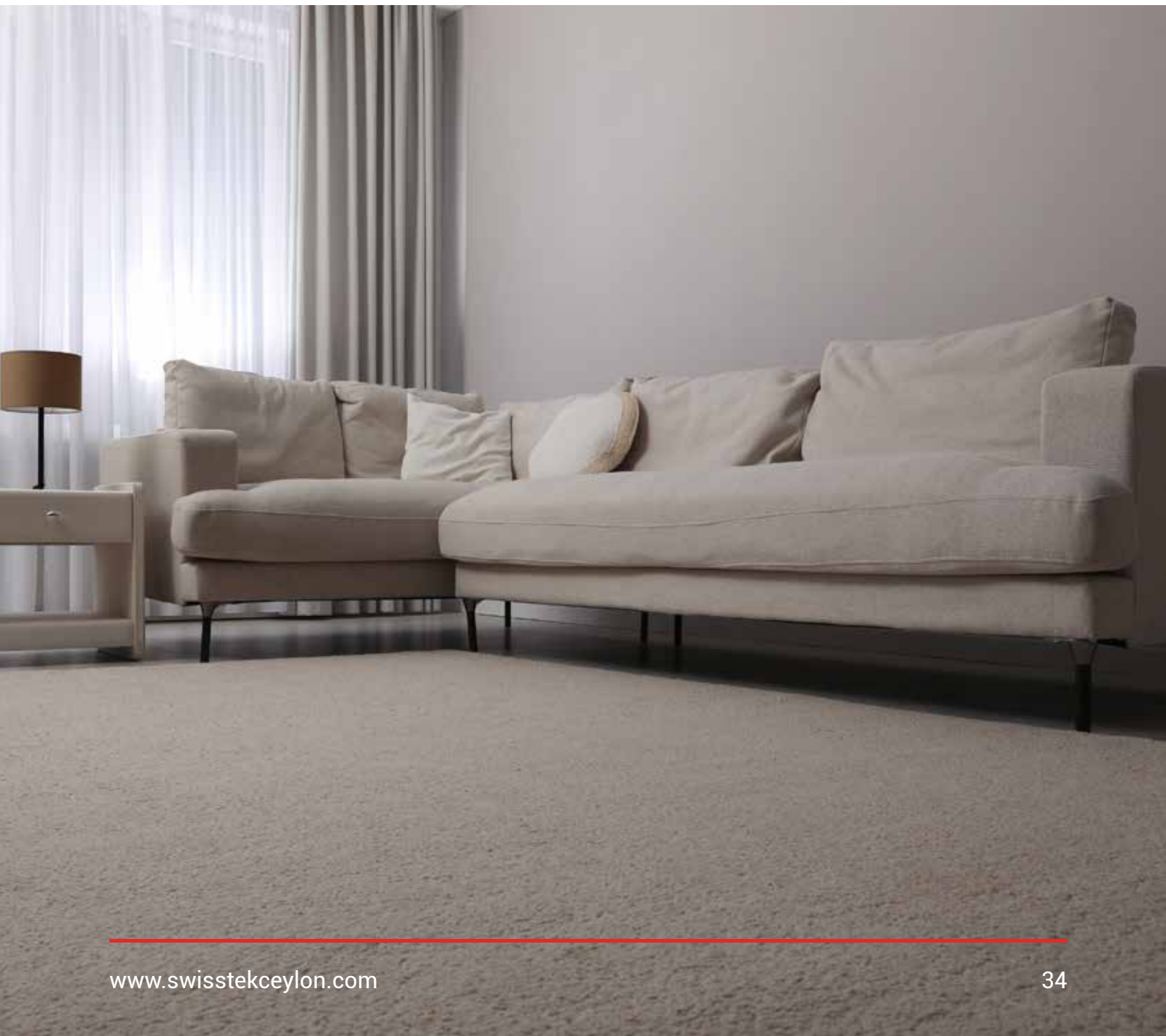



SKIM COAT RANGE

Swisstek skim coat is a textured compound, used to smooth-out surfaces of walls prior to painting. Swisstek Skim Coat is certified good quality with international standards for both interior and exterior application. Its smooth texture is a result of its water-based compound mixture, which is produced in the white color, making it versatile for any surface and ideal to meet any expectations of the customers.



Name of the Test

DELUXE SKIM COAT

PREMIUM SKIM COAT

CrackIng
Putrefaction
Flow table
Fineness

No crack
No putrefaction within 4 days
96 %
0% Retained

No crack
No putrefaction within 4 days
91 %
0% retention on 150 micron sieve

150-200
SQ. FT

COVERAGE AREA
(2MM THICKNESS)

20
KG

1KG
PER BAG



JUST ADD
WATER

2
YEARS

2 YEAR
SHELF LIFE



DELUXE SKIM COAT

Deluxe Skim Coat is an excellent product with special polymer content that can be applied on walls which will give a bright and precise finish to the wall. This will make the color you choose visible as for your expectation. The product is easy to work with and can cover more square feet. Deluxe Skim Coat is awarded with ISO quality certification. Deluxe is a recommended for indoor usage.

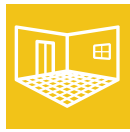

INTERNAL USAGE



BRILLIANT
WHITE FINISH



NO CRACKING
OR PEELING OFF

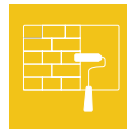

SMOOTH FINISH



HIGH QUALITY
RAW MATERIALS





PREMIUM SKIM COAT

PREMIUM Skim Coat is an excellent product with special polymer content that can be applied on walls which will give a bright and precise finish to the wall. This will make the color you choose visible as for your expectation. The product is easy to work with and can cover more square feet. Premium Skim Coat is awarded with ISO quality certification. Premium Skim coat is a specially formulated product which can be applied for interior walls as well as exterior walls. Premium skim coat is developed to withstand any weather condition.



INDOOR &
OUTDOOR USAGE



EXCELLENT
SURFACE BONDING
STRENGTH



NO CRACKING
OR PEELING OFF

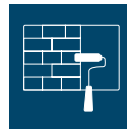

SMOOTH FINISH



HIGH QUALITY
RAW MATERIALS



BRILLIANT
WHITE FINISH

Spread Rate	20Kg(2mm thickness),150-200 square feet /Differ according to surface
Shelf Life	24 months in dry condition
Pot Life	1 1/2 hours
Touch Dry	1 1/2 hours
Thinner	Water
Color	White
Number of coat	1 or 2 as required
Mixing Ratio	7-8 liters of water per 20Kg bag
Recoat	After 24 hours
Sanding	After 24 hours
Maximum thickness of application	4mm (Two coats)

SKIM COAT RANGE

METHOD OF APPLICATION

1. Before the application Of the skim coat, remove all loosely adhering material from the wall surface with the help Of a wire brush or a sandpaper.
2. The wall surface must be free from dust particles, grease, Oil, fungus or moss.
3. Any existing damage, cracks and voids have to be repaired before the skim coat application.
4. If the surface is extreamly dried, moist the surface slightly before application.
5. 7-8 Lts. of clean water is required for 20 Kgs. of skim coat powder.
6. Mix the amount Of skim coat with the slow addition Of cold water, with a mechanical stirrer to get an excellent, cohesive and consistent mix.
7. Mix only the required amount Of skim coat at a time.
8. Apply the first coat with a putty blade or application trowel on the prepared wall.
9. Allow it to surface dry, generally not more than 12hrs.
10. Apply the second coat evenly if required.
11. After the surface dries, use sandpaper to get a smooth finish.







DECORATIVE PEBBLES

Swisstek Decorative Pebbles are used to add beauty and decorate aquariums or any other comfort space. These pebbles come in a diverse fashion of vibrant colour and picturesque beauty and available in five different colours of crystal white, black, ivory, grey and pink. These stones are designed to transform spaces into one that is elegant and has a pop of colour. These stones can be used for both interior and exterior and are of the highest quality in Sri Lanka.



**CRYSTAL WHITE
DECORATIVE PEBBLES
(LARGE)**



**CRYSTAL WHITE
DECORATIVE PEBBLES
(SMALL)**



**PINK
DECORATIVE PEBBLES
(LARGE)**



**PINK
DECORATIVE PEBBLES
(SMALL)**



**BLACK
DECORATIVE PEBBLES**



**GRAY
DECORATIVE PEBBLES**



**BLACK
AQUARIUM PEBBLES**



**GRAY
AQUARIUM PEBBLES**





GENERAL PURPOSE NON-ACIDIC SILICONE

Swisstek Silicone is designed to deliver exceptional results with its cutting-edge formula that offers unmatched sealing capabilities. Swisstek Silicone is created with the finest materials to provide higher tensile strength and excellent adhesion, which guarantees the surfaces are fully protected from any water leakages (100% waterproof). Swisstek Silicone is a non-acidic neutral silicone which is recommended for many surfaces and resistant to mold, yellowing or any surface discolorations.



High Tensile
Strength



Excellent
Adhesion



NO SAG



WATER PROOF



LESS ODOR



NON-ACIDIC



NO
DISCOLORATION



CAPABLE OF
± 25% JOINT
MOVEMENT



RESISTANCE
FOR MOLD AND
YELLOWING

TECHNICAL DETAILS

Density
Flow/Sag
Curing rate (230C/50% RH)
Tensile strength

Swisstek Silicone

1.3 g/ml
Nil
3mm/24 hours
2.0 N/mm2

COVERAGE (LINEAR METERS PER 300ML)

WIDTH IN MM		2	3	7	10	12	16	19	25
DEPTH IN MM	2	71.5m	57.0m	20.0m	14.0m	11.5m	8.5m	7.6m	5.5m
	3	-	31.5m	13m	19.5m	7.5m	5.5m	4.5m	3.5m
	5	-	-	8.0m	5.5m	4.5m	3.5m	2.5m	1.5m
	7	-	-	5.5m	3.5m	3.0m	2.0m	1.5m	1.0m

SHELF LIFE: 15 MONTHS IN SEALED CONDITION AND ROOM TEMPERATURE

SILICONEC COLOURS



CLEAR



WHITE

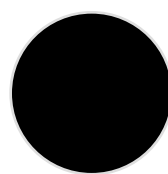

BLACK

***PLEASE NOTE THAT PRODUCT COLORS MAY DIFFER FROM THOSE SHOWN IN THE CATALOG DUE TO VARIATIONS IN PRINT PRODUCTION.**

SILICONE APPLICATION INSTRUCTIONS

1. Surfaces must be clean and dry. If cleaning is required, use an OIL-FREE solvent and dry thoroughly.
2. Cut nozzle on angle to desired bead size.
3. Apply silicone with caulking gun, pushing sealant ahead of nozzle.
4. Tooling should be done immediately as sealant will skin in 10 minutes and cure in 24hrs.

SILICONE AREA OF APPLICATION



BATHROOM/
KITCHEN



ALUMINIUM
DOORS & WINDOWS



INDUSTRIAL USAGE



GLASS & STONE
CURTAIN WALL



EXTERIOR & INTERIOR
DECORATION



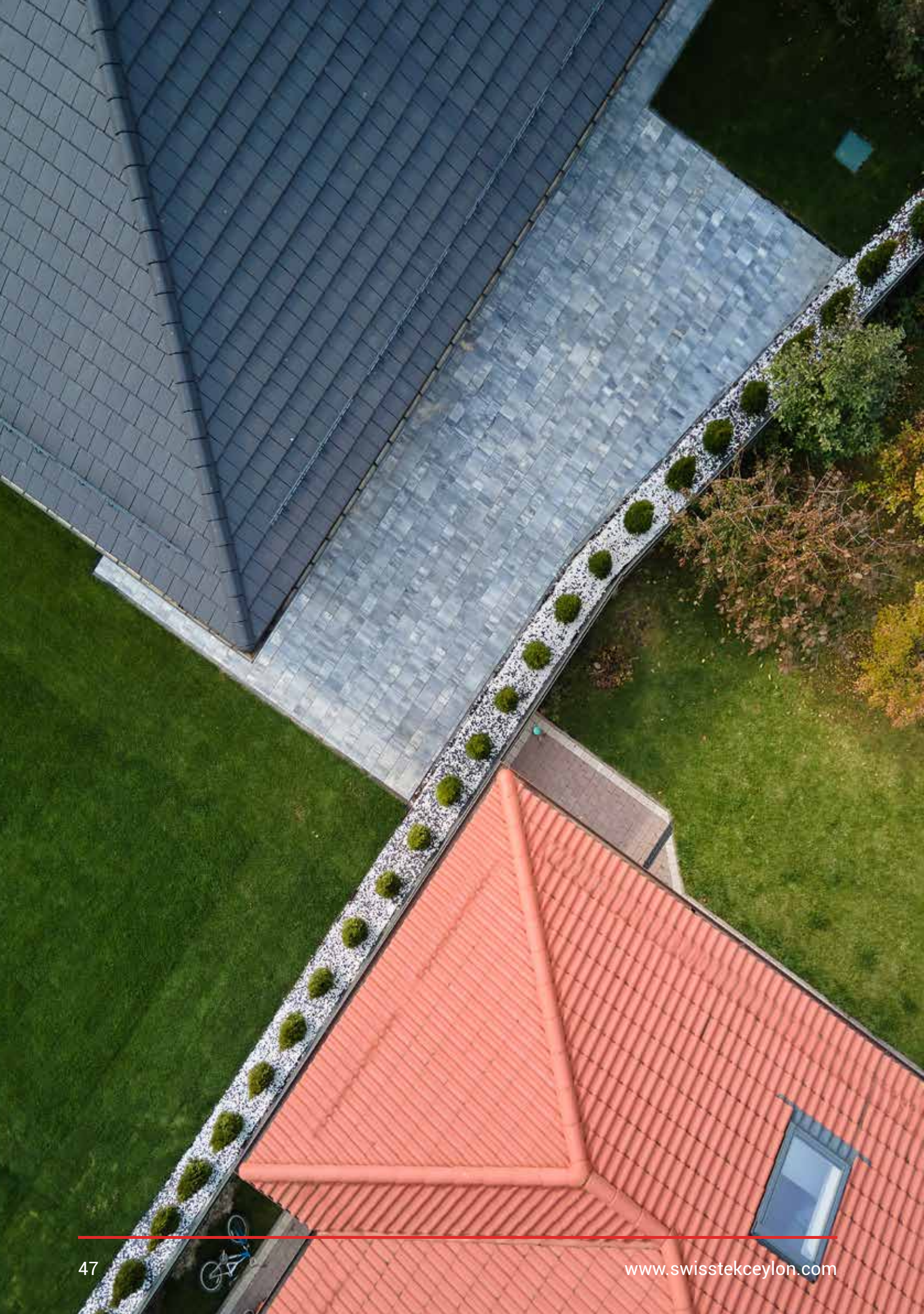

ROOF MASTER RANGE

Swisstek Roof Master is committed to offer contemporary solutions with proper Zinc Aluminum composition materials to the construction industry of Sri Lanka. The Roof Master product range includes roofing, cladding, purlins, gutters and other required accessories. Steel products have gained fame for their superiority in the Sri Lankan market within a short period as it conforms to international standards. In this spectrum Zinc Aluminum compound becomes an effective protection layer on the steel base material to prevent penetration of corrosive factors



ROOF MASTER RANGE

ZINC ALUMINIUM COATING

The AZ value determines the thickness of the Zinc Aluminium coating and confirms the anti-corrosion strength of our products. Swisstek is committed to provide the best standard Zinc Aluminium coating found in the market in both Roof Master and Roof Master +. We follow through stringent quality testing processes to make sure these standards are maintained throughout.

Our word is our bond. We ensure all our products adhere to the highest quality standards and we deliver exactly what we promise.

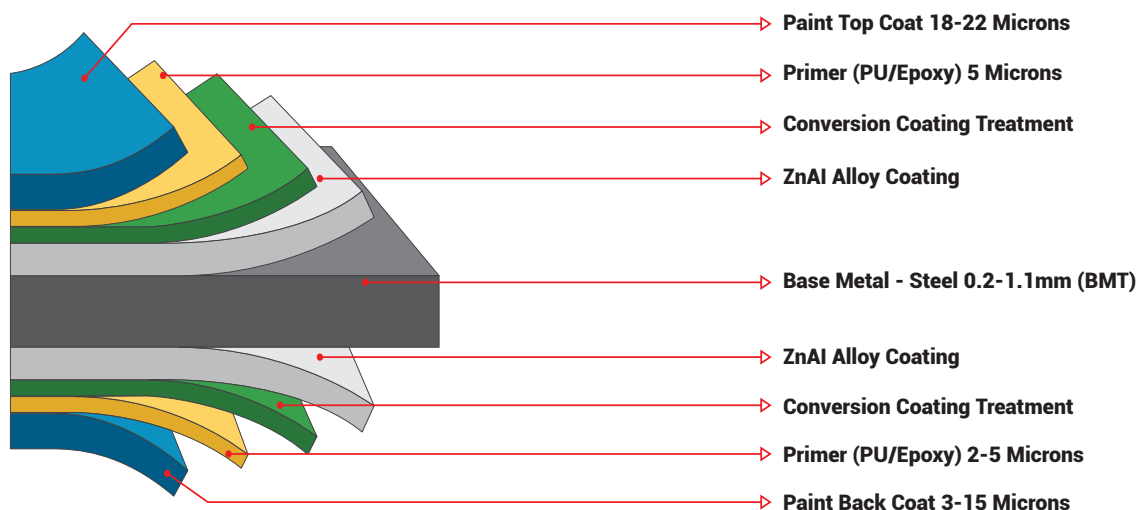

GENERAL CROSS SECTION OF THE BASE MATERIAL OF ROOFING AND CLADDING PROFILES.

ROOFING SHEETS

Swisstek Zinc Aluminium coated steel roofing. Quality has become a hallmark of Swisstek products due to strict adherence to the highest standards in sourcing material, use of state-of-the-art machinery, zero waste quality assurance process and the expertise of skilled workers. In addition to the standard sizes, Swisstek products are also geared to meet any specifications of the customers. Zinc Aluminium roofing sheets are ideal for commercial, industrial, residential buildings and many other construction requirements.

Thickness
Effective width
Total width
Mass of coating
Grade of steel/hardness
RIB height
RIB width
RIB angle

0.42, 0.47
760mm \pm 6mm
790mm
AZ 150
G 450 - 550
26mm \pm 1mm
50mm
61°

SPECIAL FEATURE: ANTI-CAPILLARY GROOVE

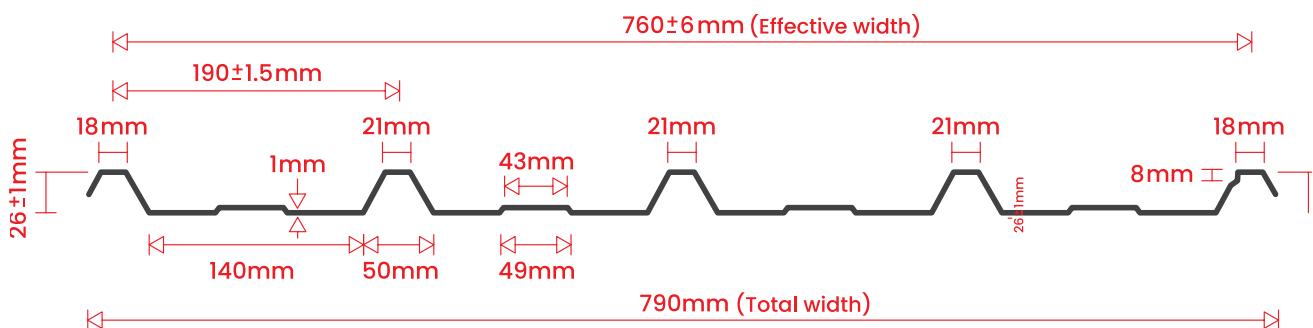

ROOFING TILES

An innovative Zinc Aluminium roofing solution to create aesthetics in your space. Contemporary designs to elevate the look of your building.

Thickness	0.35, 0.42, 0.47
Effective width	730mm \pm 5mm
Total width	795mm
Mass of coating	AZ 150
Grade of steel/hardness	G 300 - 400
RIB height	25mm
RIB width	60mm
RIB angle	53°

SPECIAL FEATURE: ANTI-CAPILLARY GROOVE

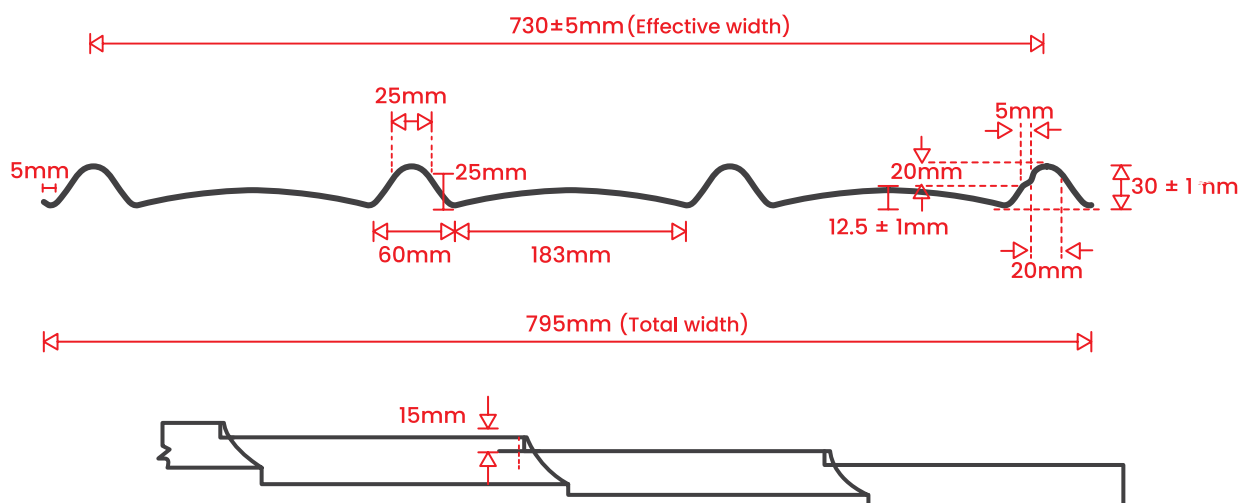

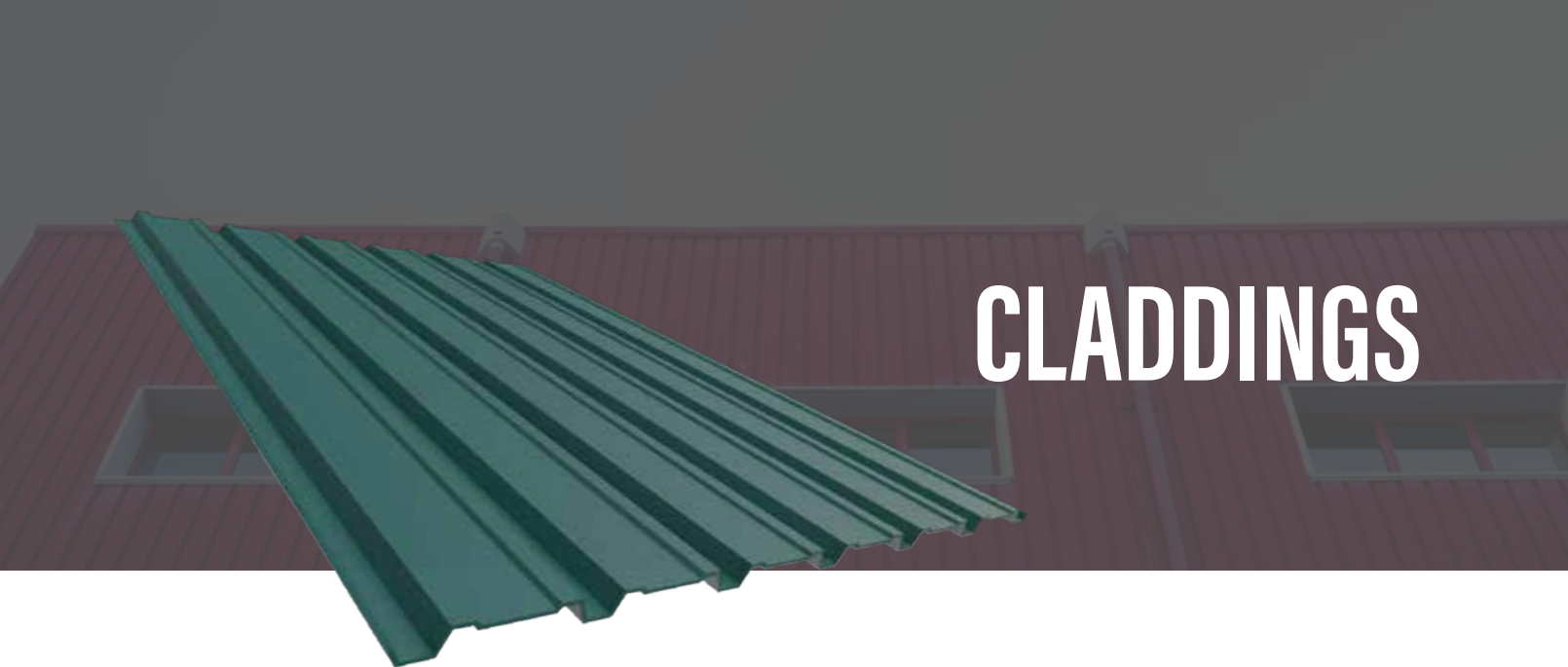

CLADDINGS

Suitable for modern steel structures such as factory buildings, warehouses and gates as well as wall claddings widely used in commercial, industrial and residential buildings. Tailor-made fabrication for custom design. Available in an array of shades to satisfy customer requirements.

Thickness	0.42, 0.47
Effective width	771mm ± 6mm
Total width	798mm
Mass of coating	AZ 150
Grade of steel/hardness	G 450 — 550
RIB height	15mm
RIB width	32mm
RIB angle	68 ± 1°

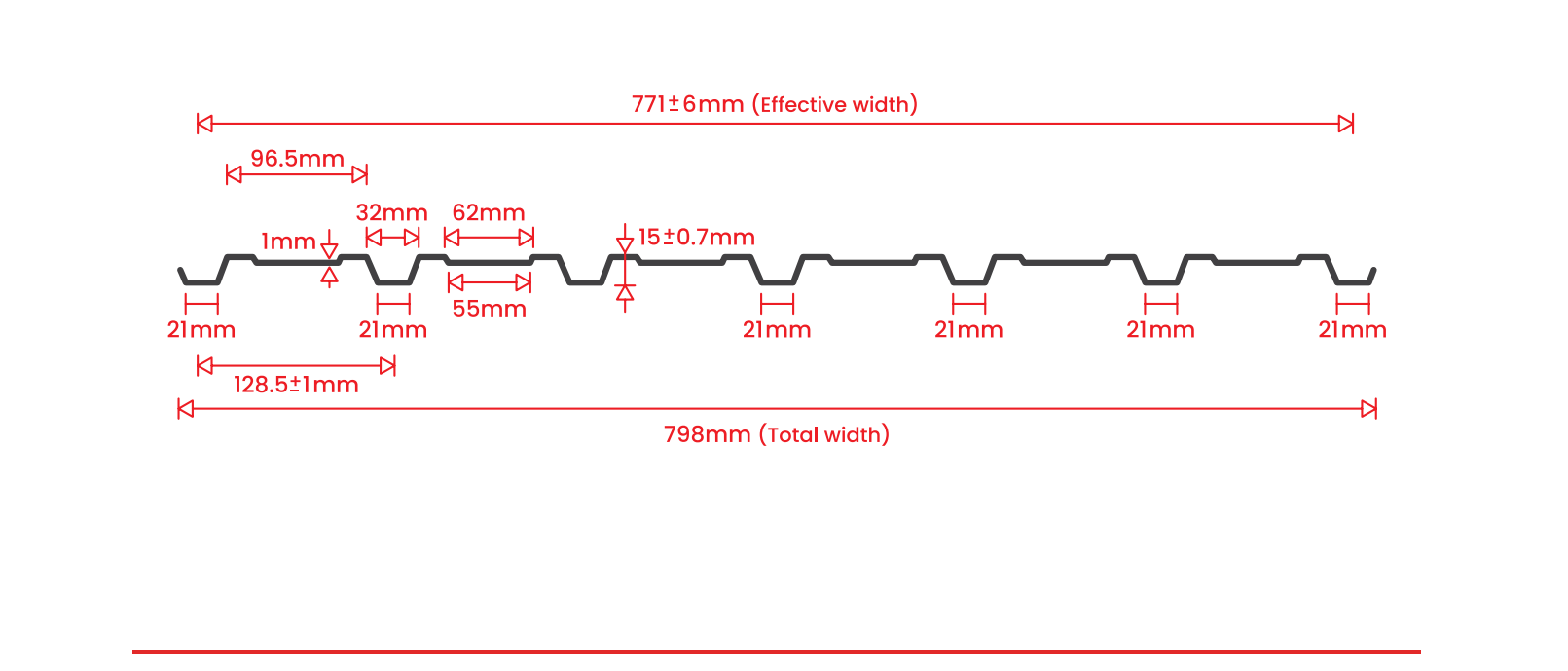

CEILING PANELS

Swisstek Ceiling Panels are engineered to deliver exceptional quality, durability, and aesthetic appeal for your ceilings as well as your walls. Our panels are meticulously crafted using premium materials and advanced manufacturing techniques, ensuring superior performance and longevity. With a focus on precision and attention to detail, Swisstek ceiling panels offer a seamless and elegant solution for both residential and commercial spaces. Available in a wide range of sizes and finishes, our panels can be customized to meet your specific design requirements.

Thickness
Pannel width
Mass of coating
Grade of steel/hardness

0.3, 0.35, 0.40, 0.47
108 mm
AZ 50, AZ 70, AZ150
G 350 - 550°

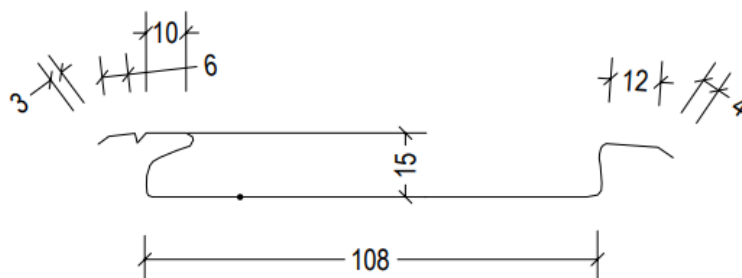

CURVE SHEETS



BULL NOSE



REVERSE CURVE



CRANKED RIDGE



AWNING



TRANSITION



**180° DOUBLE
VAULT**

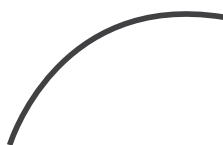

CONVEX



DOUBLE CURVE

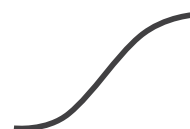

OLD GOTHIC



**CRANKED DOUBLE
CURVE**



CONCAVE

CURVED SHEETS ARE CUSTOMIZABLE ACCORDING TO YOUR REQUIREMENT

GUTTERS AND ACCESSORIES

Swisstek fabricates gutters and all other required accessories such as downpipes, bends etc., offering a complete solution in rainwater management. Technical advice is provided to customers on their request for proper installation of Swisstek Products. Our pre-engineered gutters offer faster and more convenient solutions for domestic and industrial applications. Swisstek is specialized in engineering tailor made fabrications as well. Professionals admire Swisstek Rainwater Systems because it is the 'fit & forget' solution in modern construction for effective rainwater management.

GUTTER

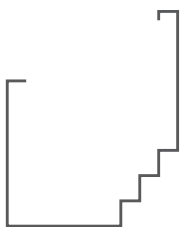

GUTTER 1

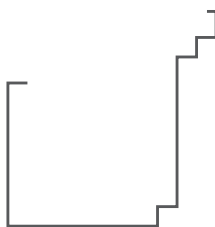

GUTTER 2

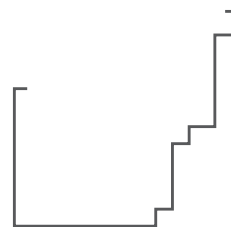

GUTTER 3

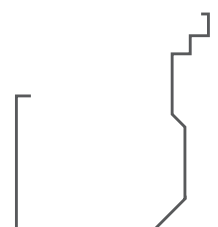

GUTTER 4

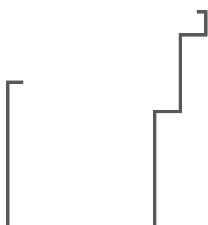

GUTTER 5



GUTTER 6



GUTTER 7

FLASHING

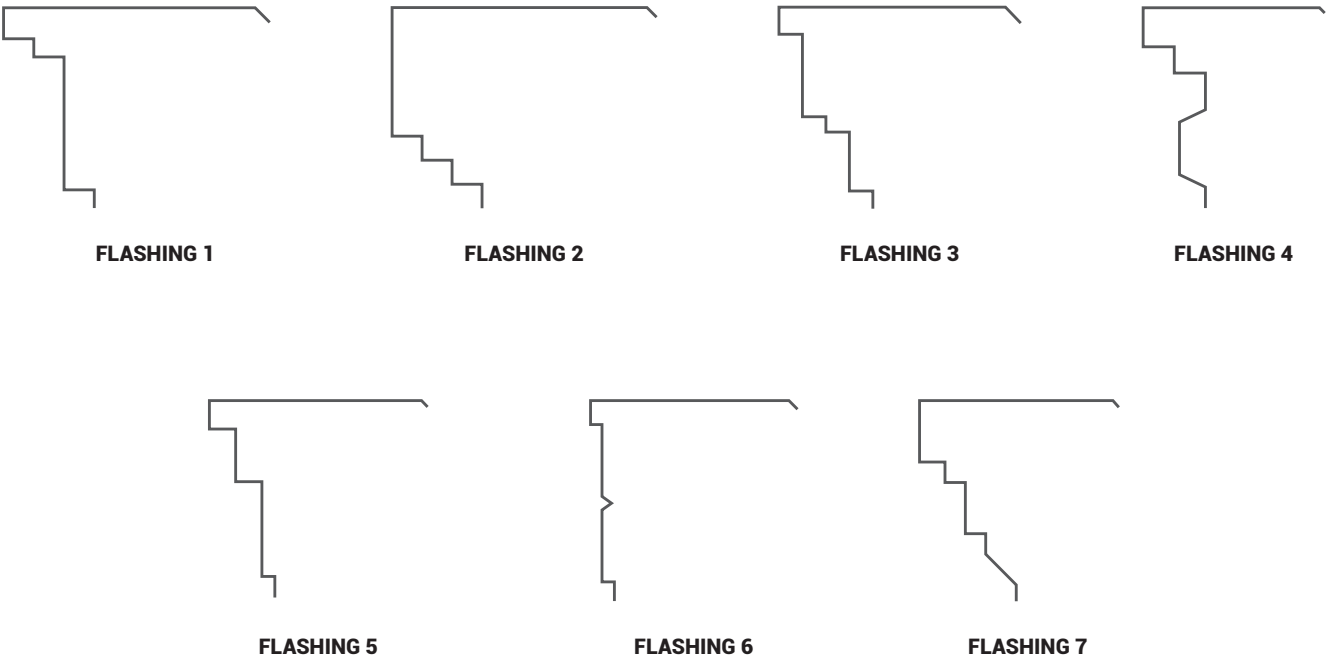

ACCESSORIES

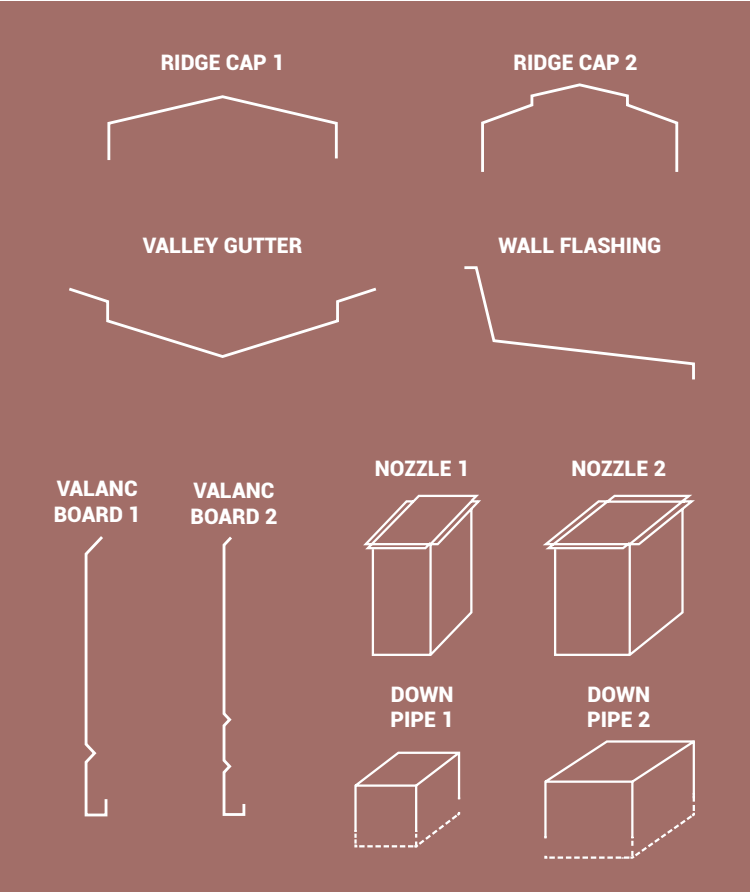
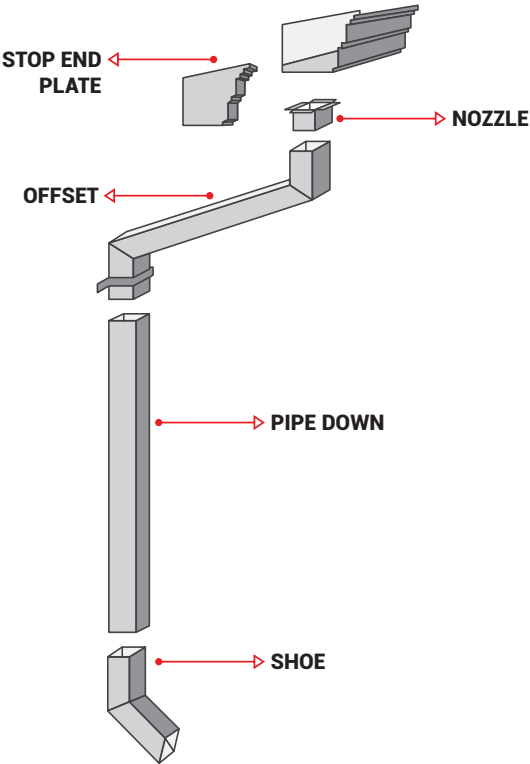

ROOF MASTER

AVAILABLE COLOURS

STANDARD COLOURS

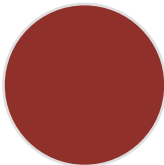

AUTUMN
RED

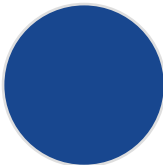

LAZURITE
BLUE

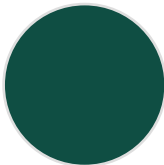

CAULFIELD
GREEN

OPTIONAL COLOURS

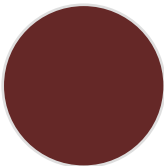

MAROON

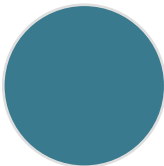

TORRES
BLUE

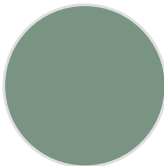

MIST
GREEN

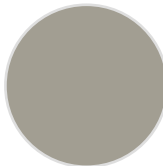

BEIGE

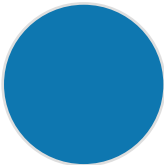

SKY BLUE



WHITE

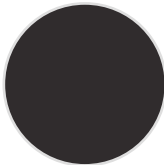

PEARL
BROWN

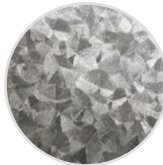

NON-COLOUR

***PLEASE NOTE THAT PRODUCT COLORS MAY DIFFER FROM THOSE SHOWN IN THE CATALOG DUE TO VARIATIONS IN PRINT PRODUCTION.**

C PURLINS



Fabricated using High Tensile Black Iron Steel with a galvanised coating up to 200. An item that's commonly used in steel building systems and steel roofs comes to you in sizes to suit your requirements and in different gauges. Mainly used for industrial and household buildings, temporary structures and many areas in the construction industry. Roof Master Purlin is an ideal product that provides long spans between portal frames on your commercial building. High in efficiency, it is quick to install and suitable for both insulated and uninsulated roofs and walls.

Thickness	Size	Galvanised coating
1.8mm	100mm x 50mm x 10mm	200
1.8mm	150mm x 65mm x 15mm	200
2.0mm	100mm x 50mm x 10mm	200
2.0mm	150mm x 65mm x 15mm	200

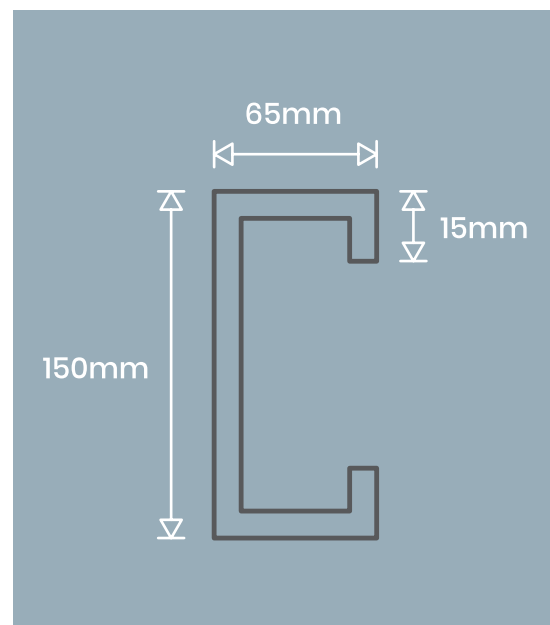
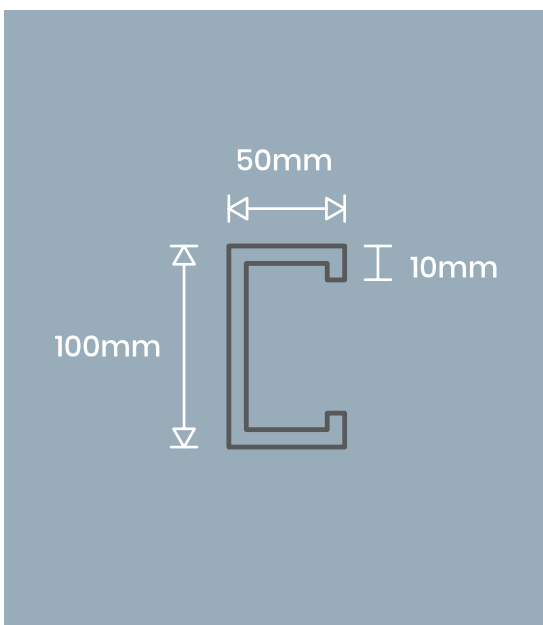





SOLID WOOD FLOORING

Transcending centuries of style, Swisstek wood flooring is the ultimate choice for a perfect finish in order to give a luxurious touch to your space. Choose from a range of different options and clothe your home in elegance that speaks volumes of classic interior and supreme durability. Swisstek wood flooring is one of the highest quality flooring options available in Sri Lanka providing nothing but the best for your space. It is sustainable and eco-friendly introducing an era of class and signature style into your homes. We specialize in the provision of high-quality sports flooring solutions and premium outdoor decking options.

Swissparkett
SOLID WOOD FLOORING



BURMA TEAK



INDONESIAN TEAK



PYINKADO



TAUARI



MERBAU



TAUKKYAN

NOTES

[illegible]



SWISSTEK CEYLON PLC

E-mail : info@swisstekceylon.com
Website : www.swisstekceylon.com

No 330, Balummahara, Imbulgoda
Telephone : +94 33 4930 590
Fax : +94 33 5701 371

HEAD OFFICE

No. 215, Nawala Road, Narahenpita,
Colombo 05, Sri Lanka.
Telephone : +94 11 4 526 700
Fax : +94 11 280 5461